

OWN THE OUTDOORS



2022 Silverstar S-Lite



FLOORPLANS

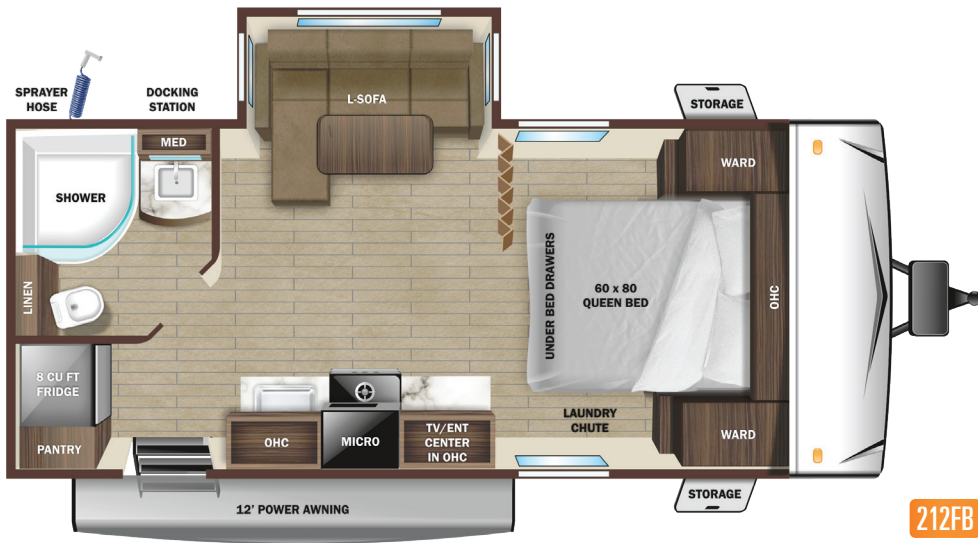

212FB



242RL

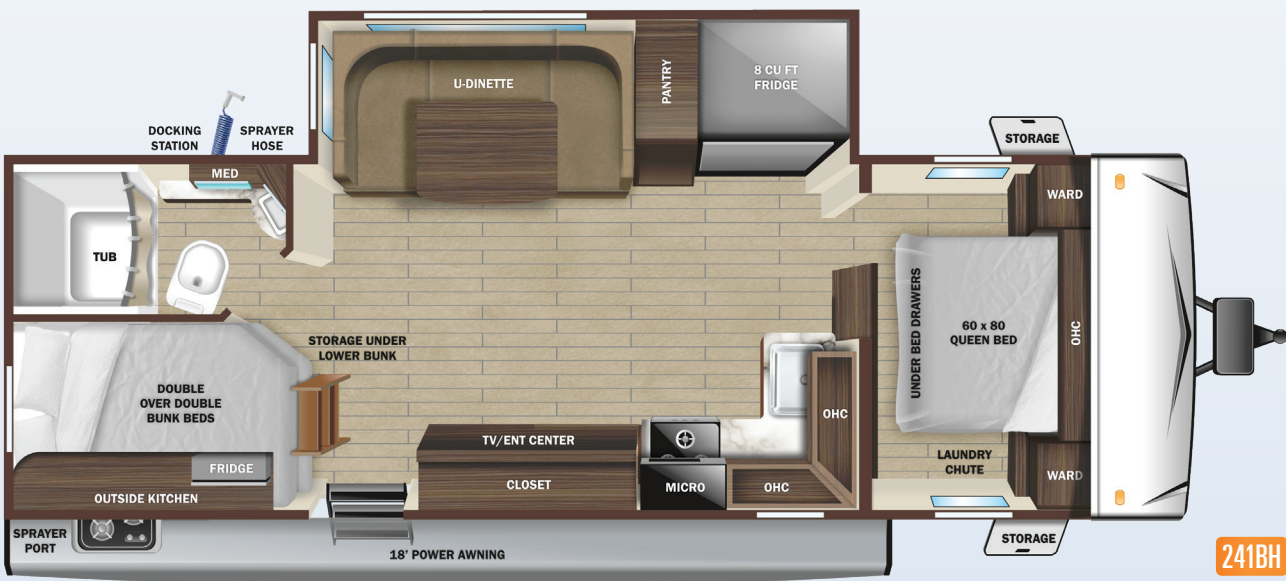

241BH

STANDARD INTERIOR EQUIPMENT

- » 60" x 80" queen bed with storage drawers below
- » 75 lb. ball bearing drawer guides
- » 81" interior height
- » Cable and satellite prep
- » Electrical outlets and USB ports in master bedroom
- » Flush floor slides with residential vinyl flooring
- » Hardwood cabinet doors
- » Kid and pet friendly – residential vinyl flooring throughout, vinyl furniture, no floor heat registers
- » Kitchen sink covers
- » Laundry chute in bedroom
- » LED interior lighting
- » Porcelain foot flush toilet
- » Range hood
- » Residential high-rise faucet with pull-down sprayer
- » Roller blackout night shades
- » Single basin stainless steel under-mount kitchen sink
- » Tri-fold sofa

STANDARD EXTERIOR EQUIPMENT

- » 5/8" main floor decking
- » Door side spray port
- » Exterior grill hookup quick connect port
- » Flexible LP lines
- » Fully-walkable roof
- » In-frame battery rack
- » Magnetic baggage door catches
- » Marine grade exterior speakers (2)
- » Oversized pass-through storage with motion lighting
- » PVC roofing membrane (limited lifetime warranty)
- » Rain guttering with molded drip spouts
- » Safety bumper with drain hose carrier and end caps
- » Self-adjusting electric brakes
- » Side camera prep marker lights
- » Solid swing-down entry steps
- » Thermal Seal - enclosed, insulated, and heated underbelly and fully insulated roof with a PVC roofing membrane
- » Tinted safety-glass windows throughout
- » TuffShell™ - vacuum bonded laminated construction, reinforced with heavy-duty fiberglass and welded aluminum frames

CUSTOMER CONVENIENCE PACKAGE (MANDATORY)

- » 15,000 BTU roof mounted A/C
- » 2-30 lb. LP bottles with cover
- » 3-burner range with 17" oven with LED lighting and flush mount glass cover
- » 8 cu. ft. refrigerator
- » AM/FM/HDMI/USB/AUX Bluetooth® sound bar stereo with indoor/outdoor zoned speakers
- » Bathroom skylight and roof vent
- » Bedspread
- » Dome style TV antenna with Wi-Fi prep
- » Enclosed exterior docking station with black tank flush
- » Entrance door with screen door, window and magnet door catch
- » EZ-store detachable cord
- » Foldable grab handle
- » Gas/electric DSI water heater
- » LED HDTV
- » Medicine cabinet
- » Microwave
- » Molded front cap with LED lighting and stoneguard protection
- » Porcelain foot flush toilet
- » Power awning with LED lighting
- » Power tongue jack
- » Powered 12V bathroom vent
- » Pressed membrane countertops
- » Radial tires with aluminum rims
- » Rear observation camera prep
- » Rear roof access ladder

OPTIONS

- » 50 amp service with 2nd A/C (282RL)
- » Electric stabilizer jacks
- » Free standing table with 2 chairs and bench (N/A 212FB, 232MD)
- » Free standing table with 4 chairs (N/A 212FB, 232MD)
- » Off-grid solar package - 12V TV, 190 watt panel, 30 amp controller
- » Theater seats ipo tri-fold sofa (N/A 241BH)
- » Wi-Fi router



We want you to spend less time worrying and more time owning the outdoors. That's why we're proud to back our products with a 3-Year Limited Structural Warranty, plus a 1-Year Limited Manufacturer's Warranty.

SPECIFICATIONS

May Include Estimated Values

	212FB	242RL	241BH
Unloaded Vehicle Weight (lbs.)	4,825	5,475	5,615
Dry Hitch Weight (lbs.)	425	645	635
Gross Vehicle Weight Rating (GVWR)	6,400	7,000	7,400
Cargo (Gross)	1,575	1,525	1,785
Exterior Length (Overall)	23' 8"	29' 6"	29' 11"
Exterior Height	11' 1"	11' 0"	11' 0"
Exterior Width	8' 1"	8' 1"	8' 1"
Exterior Width (Slides Out)	11' 3"	11' 3"	11' 3"
Interior Height	6' 9"	6' 9"	6' 9"
Fresh Water Capacity (Gal.)*	51	51	51
Gray Waste Water Capacity (Gal.)	29	29	58
Black Waste Water Capacity (Gal.)	29	29	29
LP Capacity (lbs.)	60	60	60
Tire Size	14"	14"	14"
Awning Size	12'	18'	18'

*Includes Water Heater

TO LEARN MORE VISIT
highlandridgerv.com/silverstar-s-lite



Highland Ridge RV – Part of the Jayco Family of Companies

LOCAL DEALER INFO



Due to continual research and advances, manufacturer reserves the right to change specifications, design, price, and equipment without notice, and assumes no responsibility for any error in the literature. Some items shown are not included as standard or optional equipment.