

OWN THE OUTDOORS



 **Highland**
RIDGE RV



FLOORPLANS



291RLS



292BH

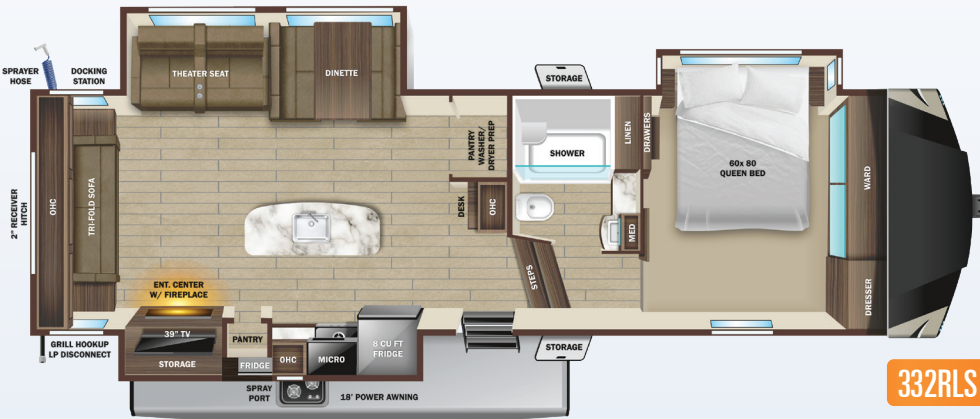

332RLS

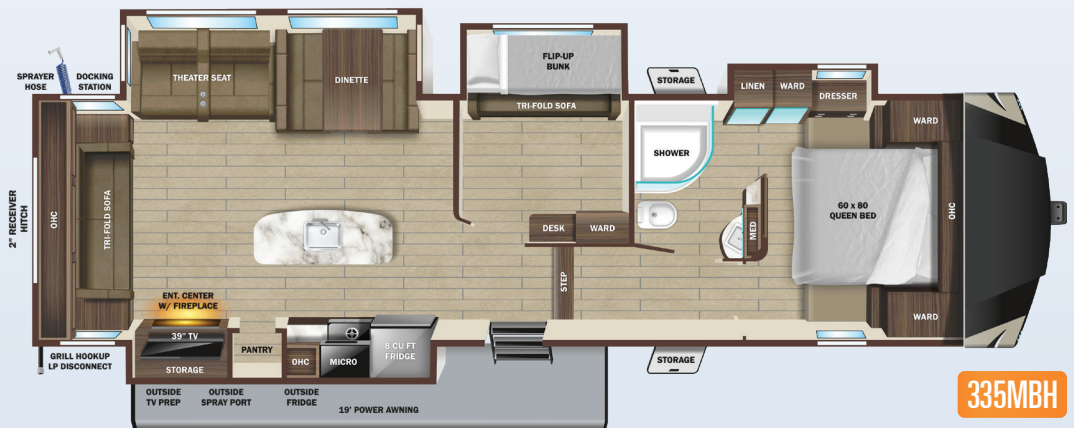

335MBH

STANDARD INTERIOR EQUIPMENT

- » 6 gal. DSI gas/electric rapid recovery water heater
- » 75 lb. ball bearing drawer guides
- » Cable and satellite prep
- » Electrical outlets on both sides of master bed
- » Fireplace
- » Flush floor slides with residential vinyl flooring
- » Glass shower doors
- » Hardwood cabinet doors
- » Kitchen sink covers
- » LED interior lighting
- » Pet and kid friendly - residential vinyl flooring throughout, vinyl furniture, no floor heat registers
- » Pocket-screwed lumbercore cabinet construction
- » Range hood vented to outside
- » Residential high-rise faucet with pull-down sprayer
- » Roller blackout night shades
- » Stainless steel under-mount sinks (kitchen and bathroom)
- » TravelINK™ - Smart RV system that allows for Bluetooth® control of awnings, lighting, slides, heating, cooling, auto levelers and more

STANDARD EXTERIOR EQUIPMENT

- » 120 GFCI protected receptacle
- » 3-20 lb. LP tanks
- » 4-point automatic leveling system
- » 5/8" main floor decking
- » 50 amp service
- » Class leading I-beam chassis
- » Equa-Flex® axle suspension
- » Exterior grill hookup quick connect port
- » Fully-walkable roof
- » Laminated wall insulation - rigid foam
- » Magnetic baggage door catches
- » Pass-through storage with motion lighting
- » PVC roofing membrane (limited lifetime warranty)
- » Rain guttering with molded drip spouts
- » Self-adjusting electric brakes

- » Side camera prep marker lights
- » Solid swing-down entry steps
- » Tinted safety-glass windows
- » TuffShell™ - vacuum bonded laminated construction, reinforced with heavy-duty fiberglass and welded aluminum frames

CUSTOMER CONVENIENCE PACKAGE (MANDATORY)

- » Battery disconnect switch
- » Enclosed exterior docking station with black tank flush
- » Kitchen sink covers
- » Painted fiberglass front cap with LED lighting
- » Radial tires with aluminum rims
- » Rear access roof ladder
- » Roof mount solar prep
- » Spare tire with bracket and cover
- » Thermal Seal - enclosed, insulated, and heated underbelly and fully insulated roof with a PVC roofing membrane

PLATINUM PACKAGE (MANDATORY)

- » 15,000 BTU roof mounted A/C
- » 17" gas oven with 3-burner range and flush mount glass cover
- » 2" receiver hitch
- » 4" tube storage bumper
- » 60" x 80" residential size queen bed
- » 8 cu. ft. refrigerator
- » AM/FM/HDMI/USB/AUX Bluetooth® sound bar stereo with indoor/outdoor zoned speakers
- » Bedspread
- » Dome style digital TV antenna with Wi-Fi prep
- » EZ-Store detachable shore cord
- » Gas/electric DSI water heater
- » Keyed-Alike™ entry and baggage doors
- » Large grab handle on main entry door
- » Large pot and pan drawer below oven
- » LED HDTV on swing arm
- » Microwave

- » Observation camera prep
- » Pass-through storage with motion lighting
- » Porcelain foot flush toilet
- » Power awning with LED lighting
- » Residential furniture
- » Stainless steel appliances
- » Storage doors in dinette base
- » Tinted safety-glass windows throughout
- » Water heater bypass

OPTIONS

- » 13,500 BTU ducted 2nd A/C
- » BBQ grill with bumper bracket
- » Free standing table with 2 chairs and bench*
- » Free standing table with 4 chairs*
- » King bed
- » Off-grid solar package - 12V TV, 190 watt panel, 30 amp controller
- » Residential 10 cu. ft. refrigerator (12V)
- » Tri-fold sofa ipo standard theater seats (292BH)
- » Turning point hitch/pin box
- » U-lounge ipo standard theater seats and booth (292BH, 332RLS, 335MBH)
- » Wi-Fi Router

* N/A with U-Lounge



We want you to spend less time worrying and more time owning the outdoors. That's why we're proud to back our products with a 3-Year Limited Structural Warranty, plus a 1-Year Limited Manufacturer's Warranty.

SPECIFICATIONS

May Include Estimated Values

	291RLS**	292BH**	332RLS**	335MBH**
Unloaded Vehicle Weight (lbs.)	8,185	8,125	9,020	9,565
Dry Hitch Weight (lbs.)	1,565	1,320	1,610	1,610
Gross Vehicle Weight Rating (GVWR)	9,995	9,995	10,995	11,500
Cargo (Gross)	1,810	1,870	1,975	1,935
Exterior Length (Pin to Rear)	31' 10"	34' 0"	34' 10"	37' 3"
Exterior Length (Overall)	32' 7"	34' 9"	35' 7"	37' 11"
Exterior Height	12' 5"	12' 6"	12' 8"	12' 6"
Exterior Width	8' 1"	8' 1"	8' 1"	8' 1"
Exterior Width (Slides Out)	13' 0"	11' 4"	13' 1"	13' 0"
Interior Height (Upper Deck)	6' 10"	6' 10"	6' 5"	6' 10"
Interior Height (Overall)	7' 11"	8' 0"	8' 2"	7' 10"
Fresh Water Capacity (Gal.)*	51	51	51	51
Gray Waste Water Capacity (Gal.)	58	58	58	58
Black Waste Water Capacity (Gal.)	29	29	29	29
LP Capacity (lbs.)	60	60	60	60
Tire Size	15"	15"	15"	15"
Awning Size	9', 11'	21'	18'	19'

*Includes Water Heater

**Specifications, weights, measurements, and capacities above are from model year 2021 and are estimates only for model year 2022. Actual specs, weights, measurements, and capacities may be different for model year 2022 than what is listed above. For the most up-to-date model year 2022 specs, please speak with your local Highland Ridge dealer, visit <http://www.HighlandRidgeRV.com>, and check the yellow sticker on the door of your Highland Ridge RV before purchasing, operating, and towing the RV.

LOCAL DEALER INFO



TO LEARN MORE VISIT
highlandridgerv.com/light-fifth-wheels



Highland Ridge RV - Part of the Jayco Family of Companies

Due to continual research and advances, manufacturer reserves the right to change specifications, design, price, and equipment without notice, and assumes no responsibility for any error in the literature. Some items shown are not included as standard or optional equipment.